

C6 COFFEE TABLE

Design: byKATO



C6 COFFEE TABLE

Design: byKATO

ANDERSEN
DESIGN SINCE 1916

2 / 3

C6 COFFEE TABLE – DESIGN ROOTED IN HISTORY

The C6 coffee table has a light and elegant appearance. Its design is based on a revamp of the legendary design icons of the 60s.

The narrow rectangular table top and slim black powder-coated metal frame create a modern contrast. The elegant brass details help accentuate the table's aesthetics.

The coffee table goes well with Andersen's LC1 lounge chairs, creating a cosy and informal corner. It also goes well with Andersen's A2 sofa to create an area for meetings, employee brainstorming, waiting areas or similar.

PRODUCT HIGHLIGHTS

- Light and elegant look in a Scandinavian style
- Choose between a tabletop in black Fenix or oak veneer
- Goes perfectly with the LC1 lounge chair or the Andersen sofa
- For informal meeting areas or waiting areas



C6 COFFEE TABLE

ANDERSEN

DESIGN SINCE 1916

Design: byKATO

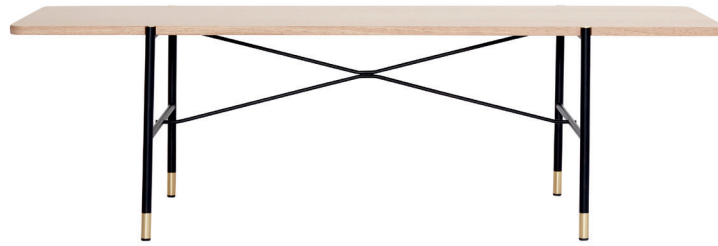

3 / 3

DIMENSIONS

C6

Length	Width	Height	Weight
140 cm	50 cm	42 cm	20 kg

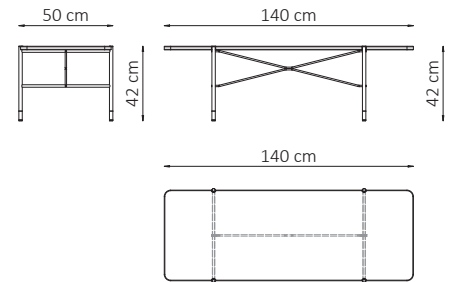

MATERIALS

Tabletop



Black Fenix laminate



White matt lacquer oak veneer

Base



Metal, black